

BLACK KATZ

Management & Lettings



1 Bedroom Apartment Rent In Bermondsey £ 310 p.w. (£1343 pcm)

1 Bedroom Apartment Rent In Bermondsey£ 310 p.w. (£1343 pcm)

<p>+VIDEO VIEWING AVAILABLE+</p><p>This beautiful very well-presented one double bedroomed apartment is situated on the third floor (Top) in this small very well kept modern development. Bright and airy with neutral decor throughout and designated parking space. This lovely apartment is set within the much sort-after South Bermondsey area, just moments from the station. This beautiful development is located on a a quiet residential street. Offering well proportioned rooms, recently redecorated with a modern open plan kitchen reception room, stylish bathroom and good sized bedroom. South Bermondsey station is a few minutes walkaway and Bermondsey Station (Jubilee Line) is also accessible, both offering direct links to London Bridge, Canary Wharf and beyond .There are also excellent and frequent buses offering options both in and out of central London. Locally you have various shops and large supermarkets on your doorstep.</p>

E.P.C. RATING: D

Property Features

. Beautiful tree lined street . Off Street Parking . Residents Parking . Fitted Kitchen . Close to local amenities . Fantastic Transport Links . 5 weeks deposit . Open plan . Private Development . Gas Central Heating . Excellent decorative order

Place of Interest Locally

Eveline Lowe Primary School - 0.38 miles. Old Kent Road Fire Station - 0.65 miles. Hatcham Temple Grove Primary School - 0.81 miles. Walworth Academy - 0.84 miles. Saint Michael's Roman Catholic School - 0.9 miles. English Martyr's Primary School - Annexe Building - 1.28 miles. London Bridge Station - 1.61 miles. Southwark Borough Council Municipal Offices (Walworth Road) - 1.64 miles. Crossways Academy - 1.67 miles. London Fenchurch Street - 1.79 miles. Saint Stephen's Church of England Primary (VA) Primary School - 1.91 miles. Saint John the Divine Church of England Primary School - 2.04 miles. Notre Dame Roman Catholic Girls' School - 2.13 miles. St George's Cathedral Catholic Primary School - 2.17 miles. O'Leary Square - 2.17 miles.



1 Bedroom Apartment Rent In Bermondsey £ 310 p.w. (£1343 pcm)

Stubbs Drive, London, SE16

Approximate Area = 468 sq ft / 43.4 sq m

For identification only - Not to scale

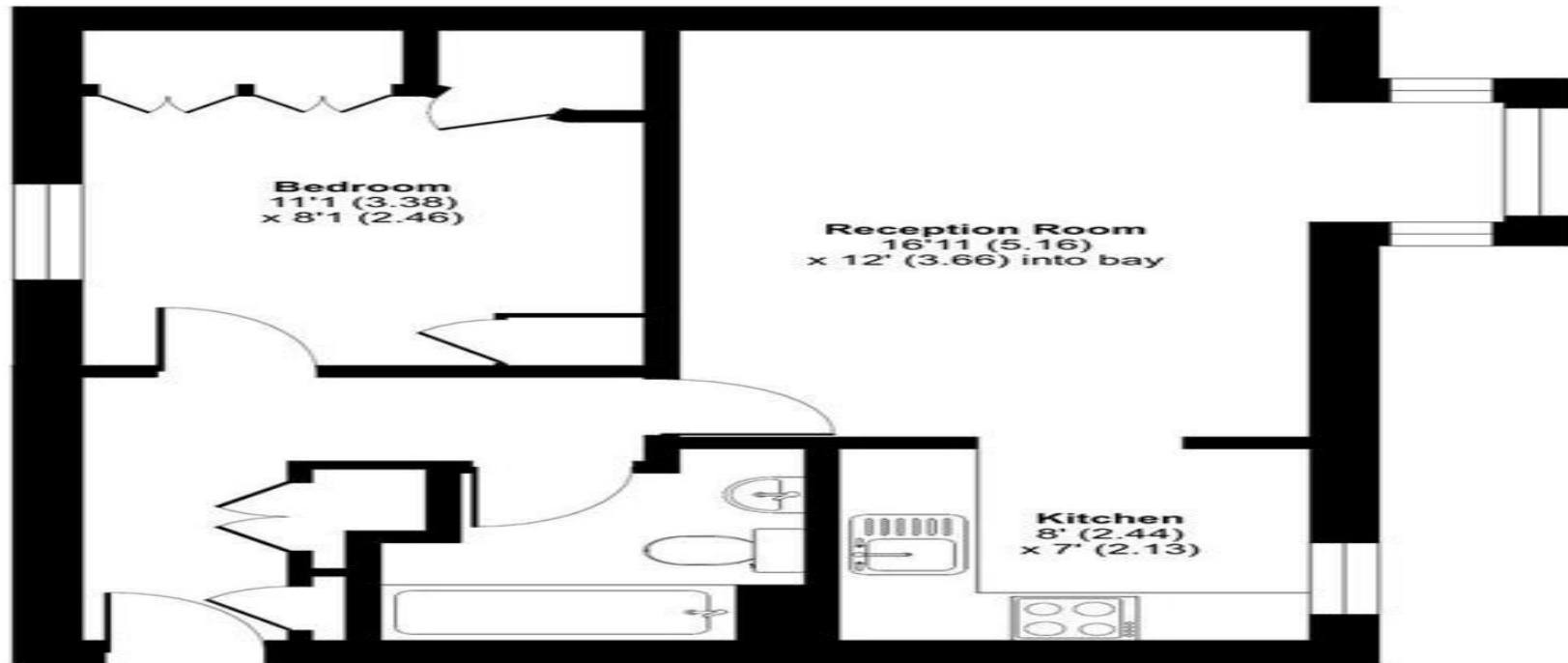

Bedroom
11'1 (3.38)
x 8'1 (2.46)

Reception Room
16'11 (5.16)
x 12' (3.66) into bay

Kitchen
8' (2.44)
x 7' (2.13)

FIRST FLOOR

1 Bedroom Apartment Rent In Bermondsey £ 310 p.w. (£1343 pcm)

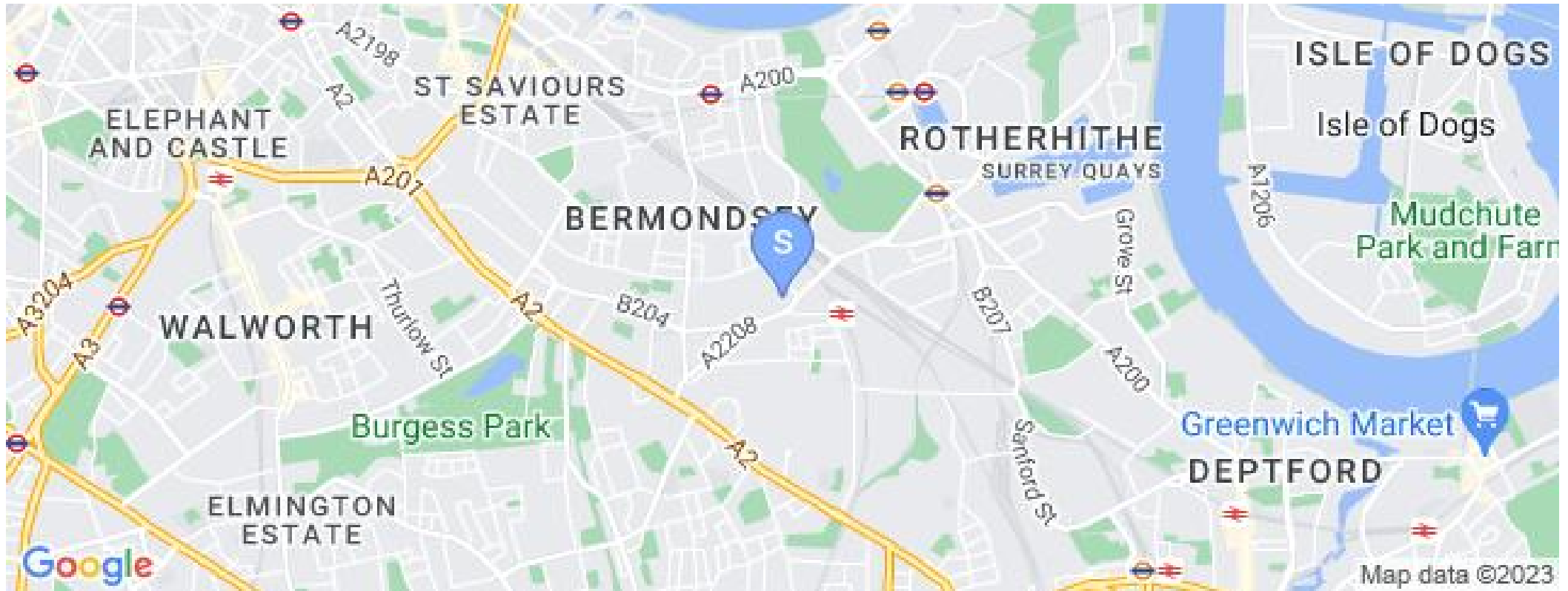

Black Katz
78 Borough High Street
London Bridge
SE1 1LL

Manager: Alex Nunzi
Email: alex@blackkatz.com
Tel: 020 7403 5010

Admin: Amy Burbridge
Email: amy.burbridge@blackkatz.com
m

Office Hours:
Mon-Fri 9.00am-7.00pm
Sat-10am-2.00pm
(Please call beforehand)

We aim to make our particulars both accurate and reliable. However they are not guaranteed, nor do they form part of an offer or contract. If you require clarification on any points then please contact us. Please note that appliances and heating systems have not been tested and therefore no warranties can be given as to their good working order.